

# TYDOM 2.0



[www.deltadore.com](http://www.deltadore.com)



<b>IT</b>	<b>Combinatore domotico IP/GSM</b>	
	Guida d'uso	2
<b>EN</b>	<b>IP/GSM home automation transmitter</b>	
	User guide	26
<b>DE</b>	<b>IP-/GSM-Telefonmodem</b>	
	Bedienungsanleitung	50
<b>ES</b>	<b>Transmisor domótico IP/GSM</b>	
	Manual de utilización	74
<b>NL</b>	<b>IP/GSM domoticazender</b>	
	Gebruikershandleiding	98
<b>PL</b>	<b>Nadajnik automatyki domowej IP/GSM</b>	
	Instrukcja użytkowania	122

### **GSM:**

Global System for Mobile communications.  
TYDOM 2.0 is connected to a wireless phone network.

GSM communications require a subscription to be taken out with an operator.

Advice before taking out your subscription:

- Enquire about your operator's network coverage for your installation.
- To prevent any interruption in the GSM network due to the expiry of a pay-as-you go or limited package SIM card, we do not recommend this type of card.

### **Maintenance mode:**

The Maintenance mode is used for activation, maintenance and diagnostic operations. This mode can only be activated if the monitoring function is off.

The alarm control unit is switched to Maintenance mode with a keypad (touch screen or simple), a remote control or a badge reader.  
(see system guide)

### **Tamper alarm:**

The products are protected against being opened or dislodged.

If a burglar tries to open or dislodge one of the products, a message is sent to the alarm control unit which triggers its indoor siren, and the system's sirens (indoor or outdoor siren, TYDOM 2.0.).

The tamper alarm is permanently activated even if the system is off.

It can be deactivated via a CLT 8000 TYXAL+ touch screen keypad.

Before opening a product, the system must be switched to Maintenance mode.

### **SMS**

Short Message Service

### **Call cycle:**

TYDOM 2.0 dials the first number in the contact list. If the contact does not pick up or if they do not acknowledge the call, TYDOM 2.0 then dials the 2nd number, then the 3rd... up to the 6th number.

If the call is not picked up, TYDOM 2.0 will repeat the cycle: 1st, 2nd, 3rd number, etc.

TYDOM 2.0 makes up to 16 consecutive calls or 4 cycles at the most.

### **IP**

*'Internet protocol'*



Operation performed in Maintenance mode (see guide for CS 8000 TYXAL+ alarm control unit § Maintenance mode)



Use this device in line with the regulations in force and local restrictions. They can be applicable for example, in petrol stations, hospitals, etc.



This device can disrupt the operation of medical devices (hearing aids, pacemakers). Consult your doctor for more information.

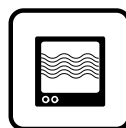

This device can cause disturbances near television screens, radio sets and computers.



Do not use the device in a room with a risk of explosion (e.g. close to a source of gas, fuel or chemicals).

The connection quality of your product may be affected due to changes on the IP architecture on which it operates. These changes may involve (the list is not exhaustive) a change in hardware, software update or configuration operations, work on your operator's equipment or any other multimedia devices such as tablets, smartphones, etc.' Android™ and Google play are Google Inc trademarks. IOS™ is a Cisco Systems Inc trademark. WiFi is a Wireless Ethernet Compatibility Alliance trademark. Because of changes in standards and equipment, the characteristics given in the text and the illustrations in this document are not binding unless confirmed.

<b>1. How does TYDOM 2.0 work?</b>	<b>28</b>
1.1 Functions	28
1.2 Operation	29
1.3 Home automation functions	30
1.4 Compatible products	30
1.5 Notifications if there is an alert	31
1.6 Alert cycle upon detection of a DMBV TYXAL+	32
1.7 Calling TYDOM 2.0 with speech synthesis	33
1.8 View events	34
1.9 Remote viewing	35
<b>2. Personalising TYDOM 2.0</b>	<b>36</b>
2.1 Personalising the transmitter with a user code	36
2.2 Naming TYDOM 2.0	36
2.3 Call numbers	37
2.4 Configuring the SIM card	37
2.5 Voice/text messages	38
2.6 SMS alert for designated contacts function	38
2.7 Auto attendant	39
<b>3. Connect to the system with the TYDOM application</b>	<b>40</b>
<b>4. TYDOM application features</b>	<b>40</b>
4.1 Home screen	40
4.2 Navigation	41
4.3 Key to symbols	42
4.4 Changing the order of menus	42
<b>5. Correct operation test</b>	<b>43</b>
<b>6. Telephone line LED status</b>	<b>44</b>
<b>7. Backup mode</b>	<b>44</b>
7.1 Mains power failure	44
7.2 Internet connection down	45
<b>8. Battery replacement</b>	<b>46</b>
<b>9. Advanced functions</b>	<b>47</b>
<b>10. Troubleshooting</b>	<b>48</b>

# 1. How does TYDOM 2.0 work?

## 1.1 Functions

TYDOM 2.0 is connected to a GSM telephone network and to the Internet via an ADSL box. It is associated with the alarm control unit via wireless communication.

It enables:

- remote control of the alarm (using the TYDOM application).
- notifications by a call or text message to another telephone, or a remote monitoring centre (protocol: Contact ID, subscription required).
- The **Video function** (with a DMBV TYXAL+ video detector) makes it possible to:
  - Receive notifications in the event of intrusion via SMS with a video link stored on a protected server.
  - Make a remote display request from home with the TYDOM application (TYDOM 2.0 has to be connected to the Internet, and a DATA package on smartphone or WIFI access are required).
- Receive a SMS when the system is activated/deactivated (configurable)
- Perform an audio confirmation with intercom function
- Remotely control your heating and control systems, if your installation includes X3D products.
- Create scenarios.
- View the installation's ambient temperature.

In the event of an alert, the outgoing call via the GSM network (even if there is a power outage) is used to:

- Describe the alarm
- Listen in on what is happening on the premises monitored and to speak simultaneously
- Stop the call cycle
- Deactivate the sirens



### TYDOM application

IOS and Android  
(for smartphones and tablets):

- Control (locally or remotely on-line) all your equipment: heating, lighting, roller shutters, control systems and scenarios
- Display consumption details (electricity, gas, water, etc.), with a product from the RT2012 range in Kwh or euros
- Report status of control settings (temperature in home, lighting, etc.)
- Personalisation with icon library and indoor photos
- Manage up to 10 sites (apartments, second homes, shops, etc.)



## 1.2 Operation

TYDOM 2.0 and other products of the TYXAL+ range, intrusion detectors, technical detectors, sirens, keypads or remote controls will be associated with the CS 8000 TYXAL+ alarm control unit (50 products max.).

EN

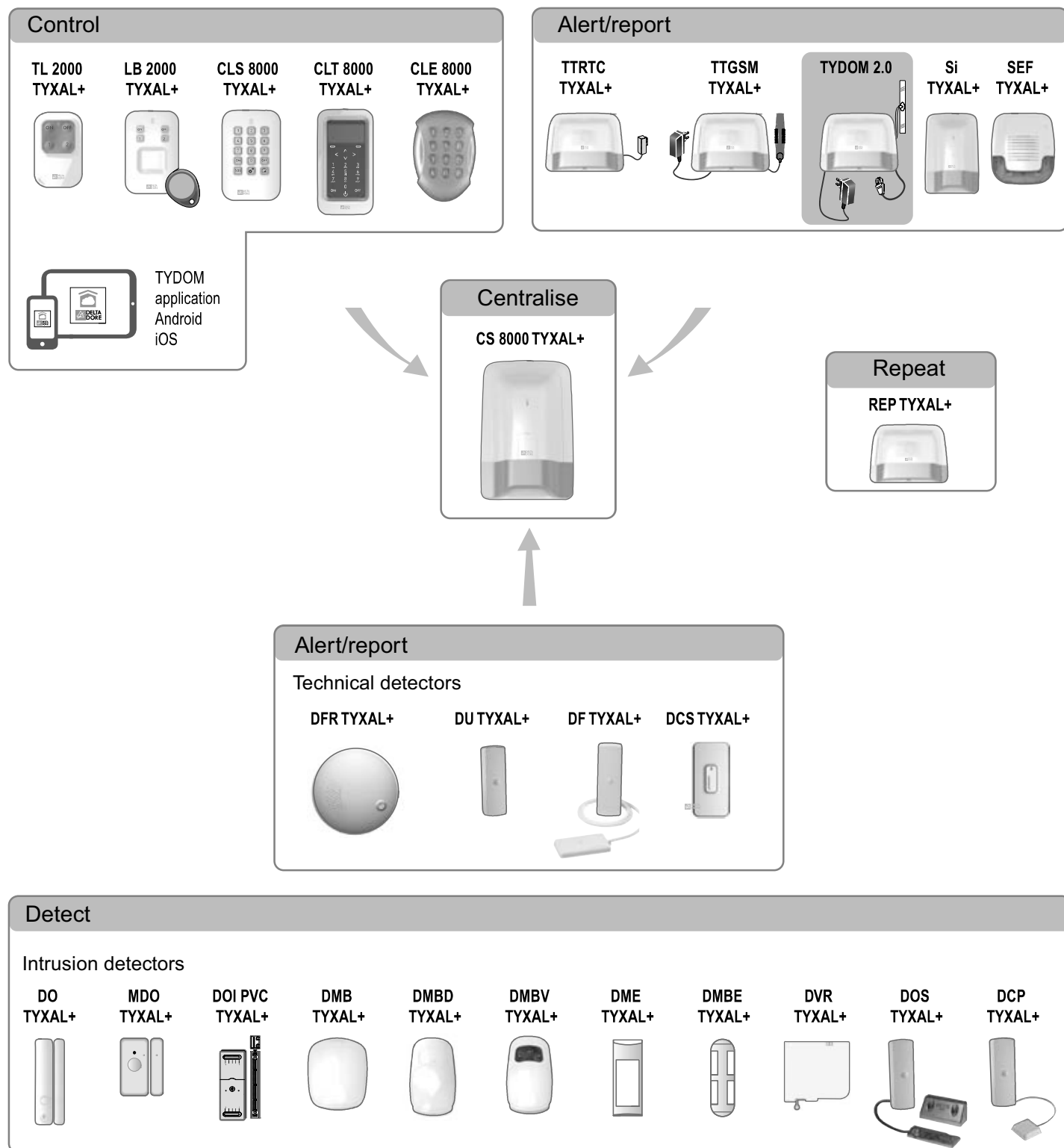

## 1. How does TYDOM 2.0 work?

### 1.3 Home automation functions

The home automation functions remotely enable you to:

- Adjust house temperature (with 32 heat sensors divided over 8 areas)
- Centralised lighting control, creating lighting moods (32 sensors)
- Control position of roller shutters and blackout blinds (32 channels)
- Control and view the status of your Tyxal+ alarm
- Control numerous control systems (gate, garage door, motors, sprinklers...) (32 channels)
- Create up to 16 scenarios to simplify daily activities (e.g. Leaving the house: all lights turn off, shutters close and alarm is activated)

- Detailed daily consumption display (heating, hot and cold water, gas, electricity) and history log per day/week/month/year
- Reports for main control settings (house temperature, alarm active, etc.)
- Multi-site management: up to 10 home automation gateways managed remotely

These functions can be performed if the equipment allows (X3D receivers).

You can check it with our customer services.

### 1.4 Compatible products

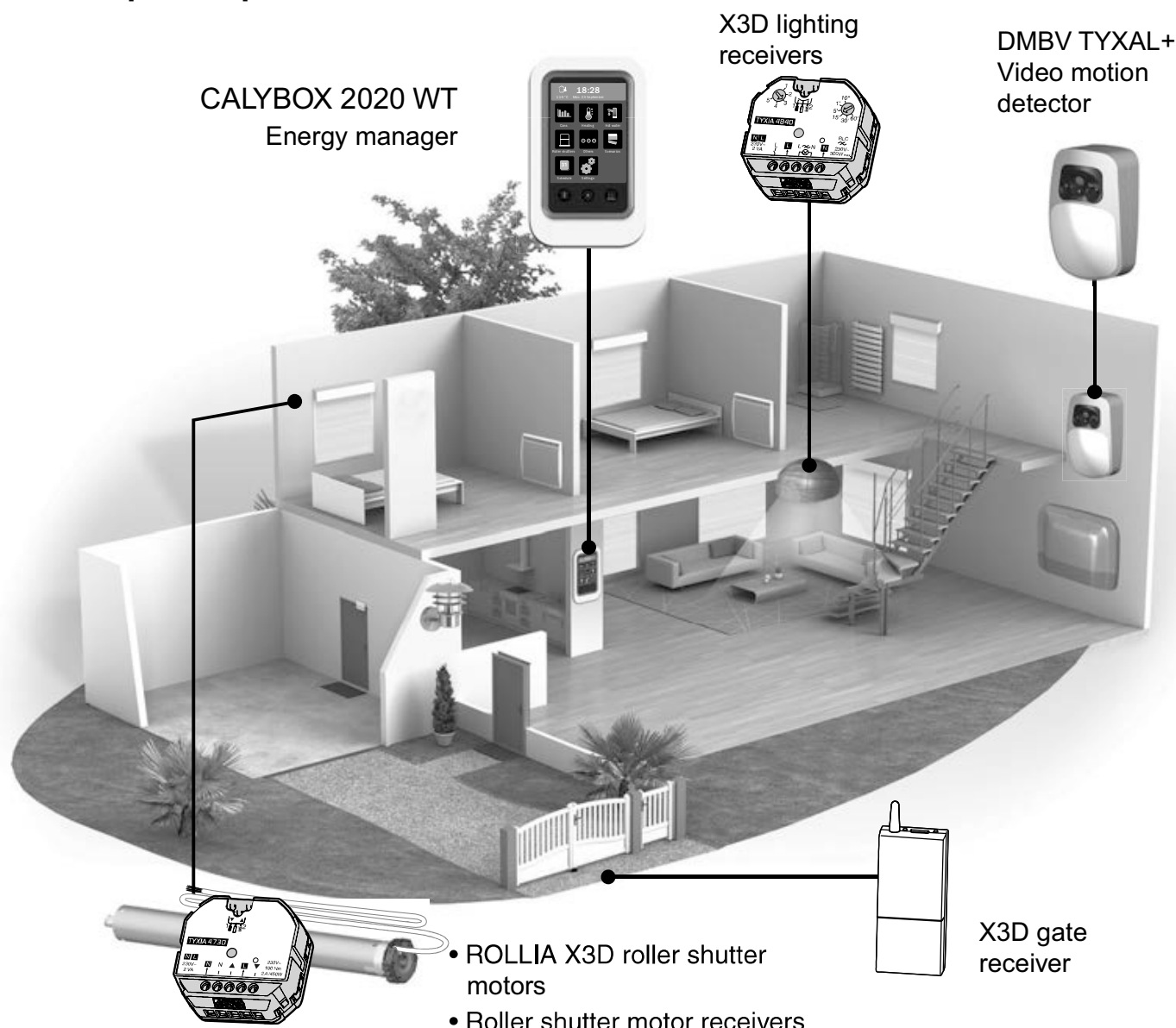

## 1.5 Notifications if there is an alert

### Process of a call cycle in the event of an intruder alarm or technical defect

For an alert (intruder alarm or technical defect), TYDOM 2.0 calls the recorded numbers (6 max.) in turn until a contact stops the call cycle.

- ❶ The transmitter dials the first recorded number, if the contact does not pick up or if they do not acknowledge the call, the transmitter then dials the 2nd number, then the 3rd... up to the 6th number.
- ❷ If no contact picks up, the transmitter repeats the cycle: no.1, no.2, no.3, etc.

Hence, the transmitter makes 16 consecutive calls.

The cycle stops automatically after 16 calls.

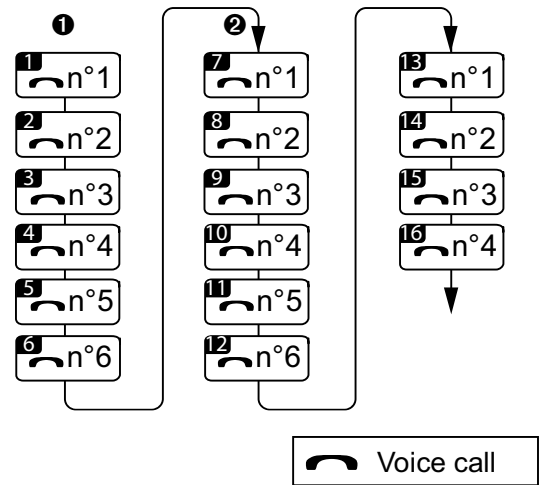

To stop the call cycle, press the button.

For a technical defect (except for smoke detectors), the call is triggered after 30 seconds.

## 1. How does TYDOM 2.0 work?

### 1.6 Alert cycle upon detection of a DMBV TYXAL+



DMBV TYXAL+ detects any moving presence in the room via infrared both during the day and at night.

If a presence is detected, DMBV TYXAL+ sends the video to TYDOM 2.0.

Upon request via the application, DMBV TYXAL+ sends the video to TYDOM 2.0.

You will receive a secured link prompting you to watch the video via SMS.

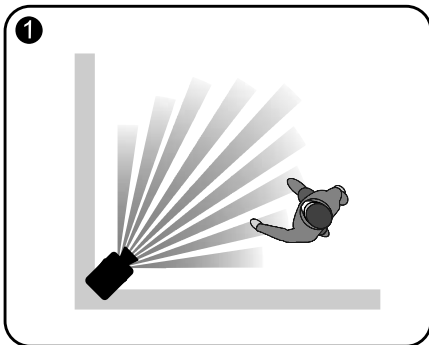

- Motion detection.
- Sends a text message or starts a call cycle.
- Acquisition of a 5 second long video.

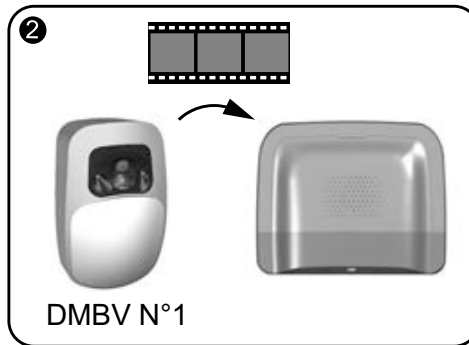

DMBV TYXAL+ sends the video to TYDOM 2.0.

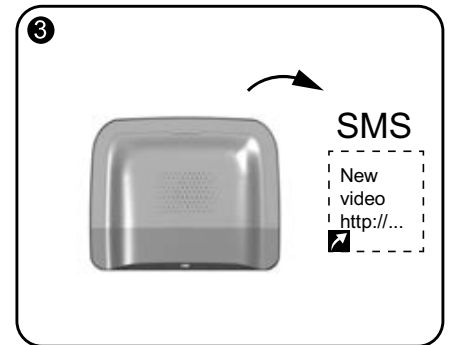

TYDOM 2.0 alerts and sends you the video link via SMS.

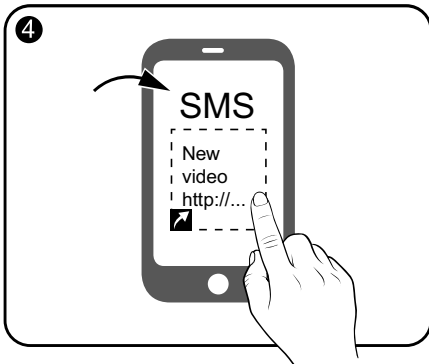

- The alert is sent to your smartphone.
- Click on the secured link.

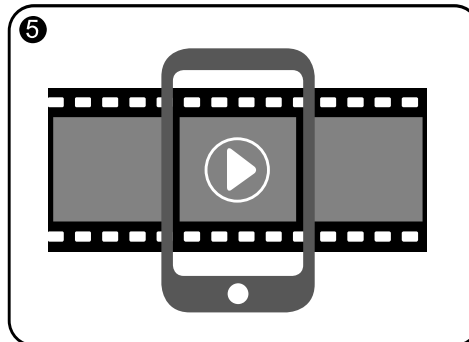

Watch the video.  
(To view the MPEG-4 format, you might have to install a compatible application)

A programmed number with SMS distribution option will automatically receive the video link in case of intrusion. (upon detection of a DMBV TYXAL+)

The link to the video is secured.

The recorded videos are stored and accessible for a period of 30 days before being deleted.



## 1.7 Calling TYDOM 2.0 with speech synthesis

Tamper alarm example:

EN

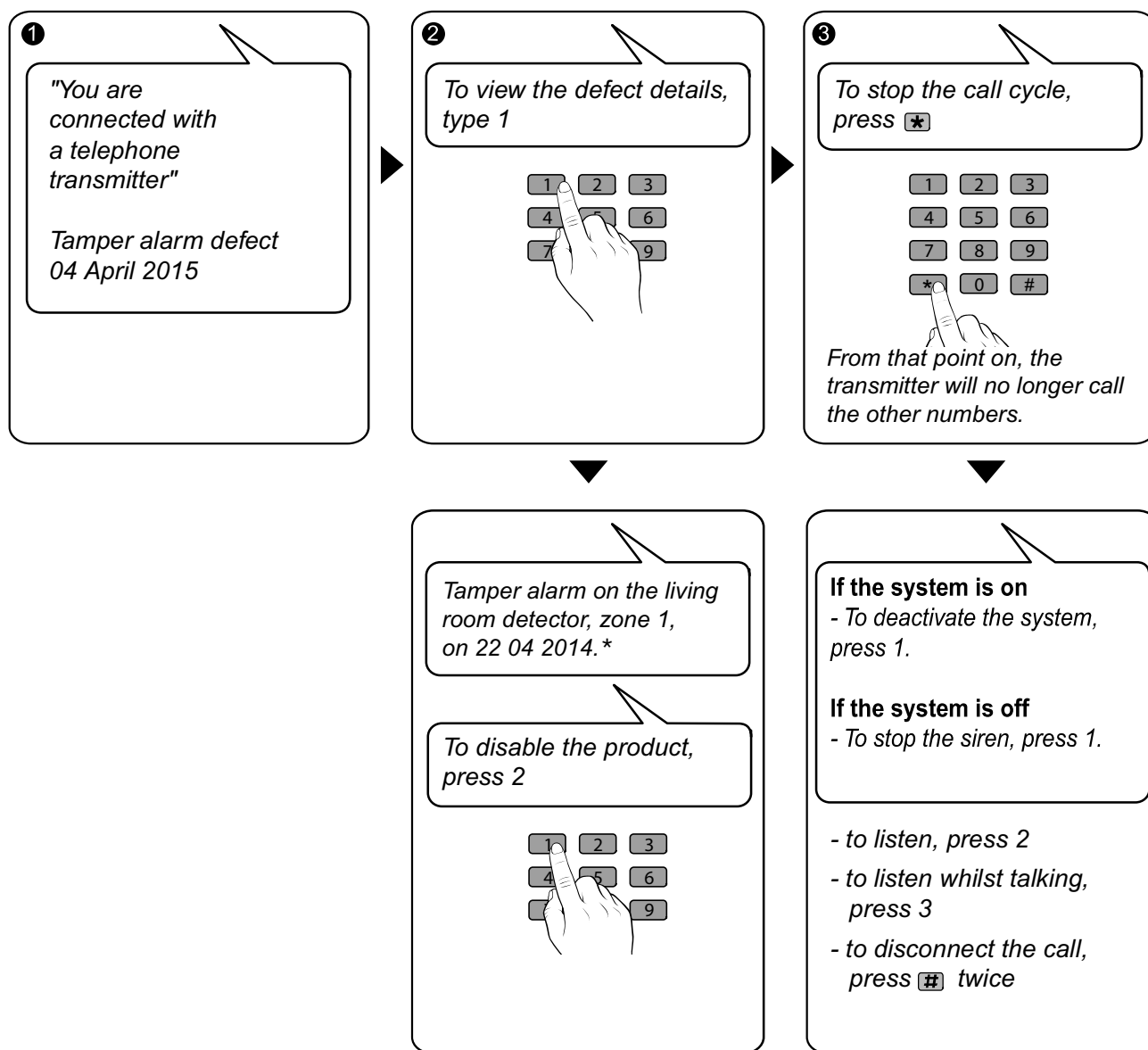

\* Example of room and zone name.

The message depends on the way you have configured your installation.



You must press the \* button before hanging up to stop the call cycle so that the transmitter does not call the other numbers.

## 1. How does TYDOM 2.0 work?

### 1.8 View events

To view the list of events on your system:

- **With the TYDOM application**



- Run the TYDOM application



Alarm

- Press the 'Alarm' icon
- Enter your code (6 digits)

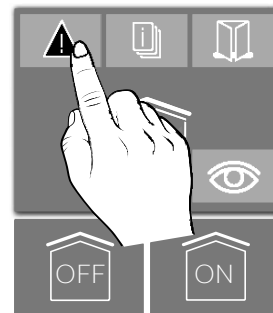

- Press the defect notification icon
- Select the 'Unacknowledged events' menu

- **With speech synthesis**

Call TYDOM 2.0, after entering your code, TYDOM 2.0 displays the list of events that occurred on your system.

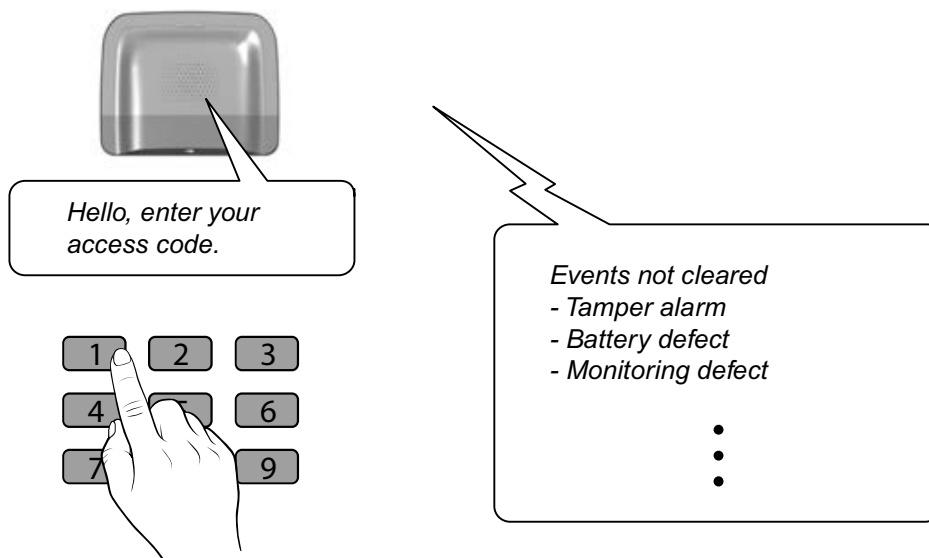

## 1.9 Remote viewing

You can activate the remote viewing of the room protected by a DMBV TYXAL+ at any time.  
You will receive a secured link prompting you to watch the video via SMS.

EN



- Run the TYDOM application



Alarm

- Press the 'Alarm' icon  
- Enter your code (6 digits)

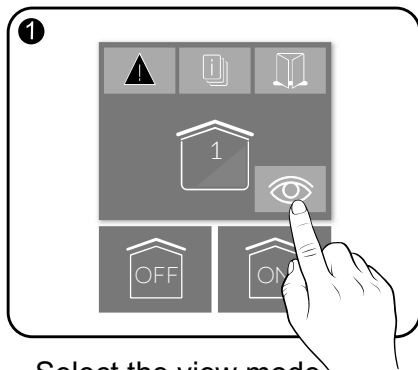

- Select the view mode.

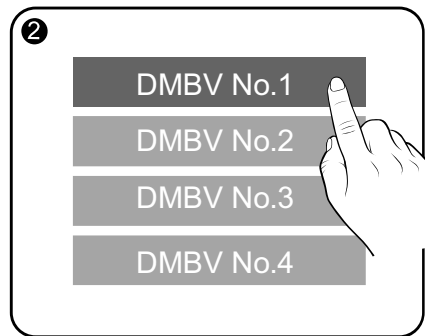

- Select the required detector.

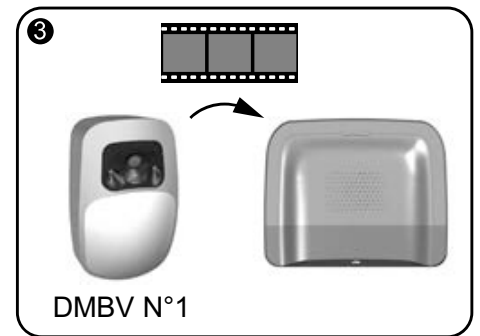

- Acquisition of a 5 second long video.

DMBV TYXAL+ no.1  
sends the video to TYDOM 2.0.

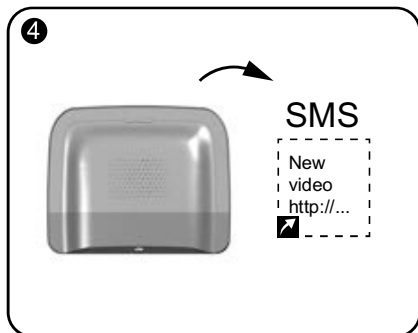

TYDOM 2.0 sends you the  
video link via SMS.

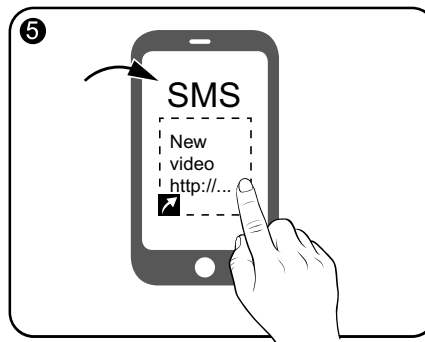

- Click on the secured link.

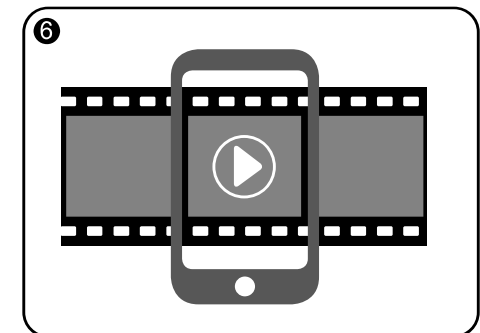

Watch the video.

(To view the MPEG-4 format, you  
might have to install  
a compatible application)

The link to the video is a secured.

The recorded videos are stored and accessible for a period of 30 days before being deleted.

## 2. Personalising TYDOM 2.0

### 2.1 Personalising the transmitter with a user code

- **From the touch screen keypad**

Use the touch screen keypad interface to configure your transmitter even more easily.

The table opposite shows the functions that can be personalised on TYDOM 2.0 from the CLT 8000 TYXAL+ touch screen keypad.

(Menu: **Installation > Products > Configure**).

- **Without touch screen keypad**

Set the alarm control unit to maintenance mode (see system guide)

Call the transmitter and let the speech synthesis system guide you.

### 2.2 Naming TYDOM 2.0

This menu is used to select a specific name for the transmitter.

❶ Enter the installer code (123456, by default) and confirm with OK.

❷ Press **Settings**, then select the menu:  
**Installation > Products > Configure**

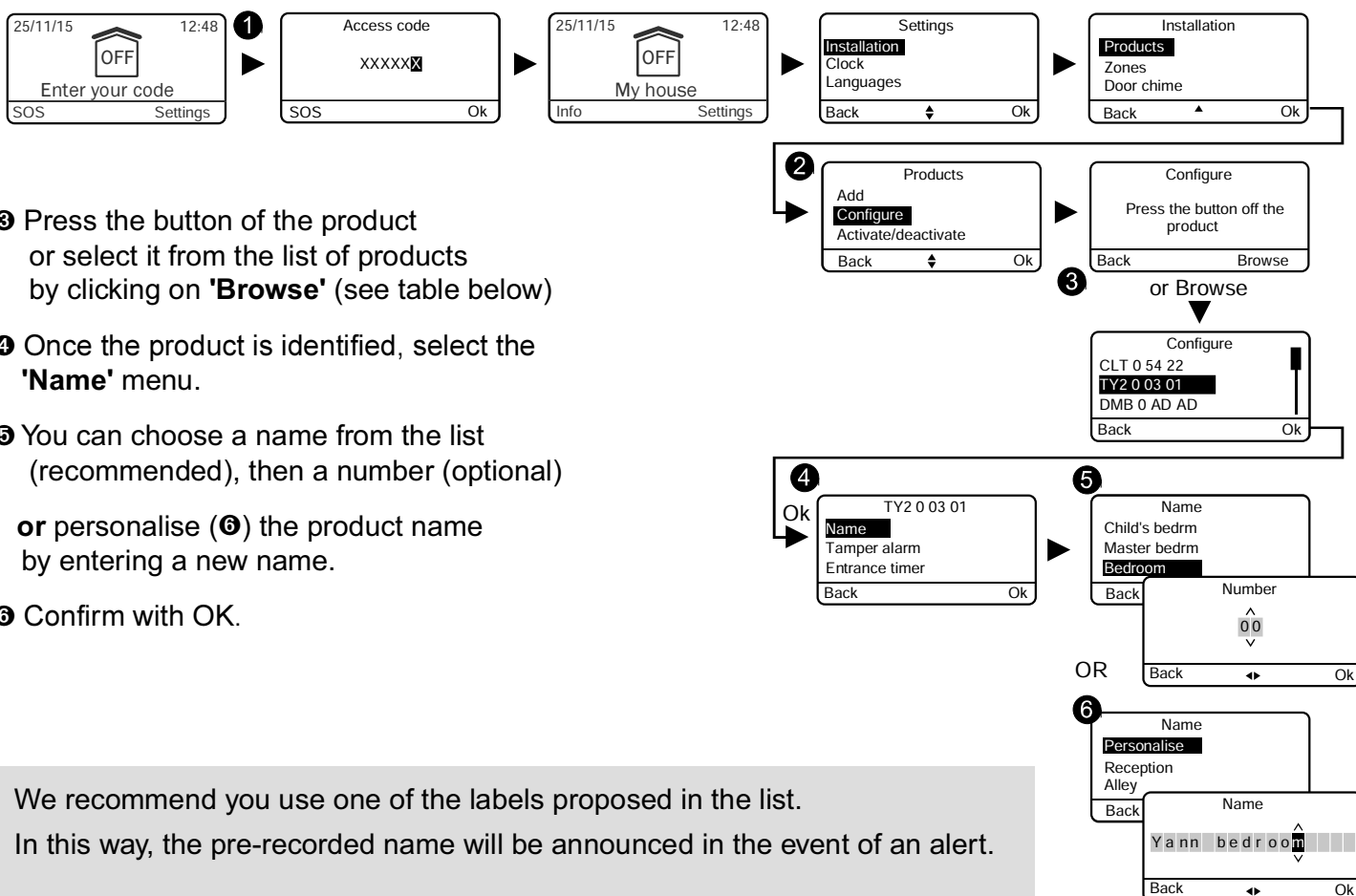

## 2.3 Call numbers

This menu is used to programme the numbers that will be called if there is an alarm, technical defect or to send video links.

EN

❶ Enter the installer code (123456, by default) and confirm with OK.

❷ Press **Settings**, then select the menu:  
**Installation > Products > Configure**

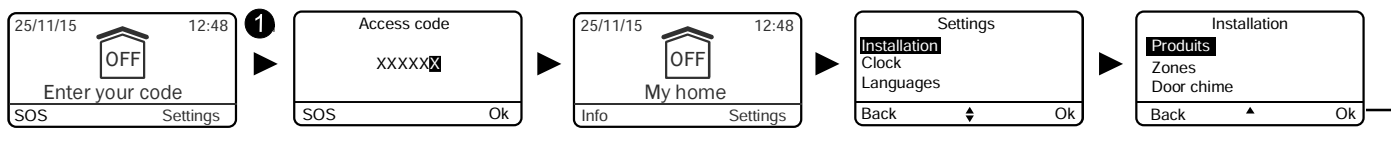

❸ Press the button of the transmitter or select it from the list of products by clicking on '**Browse**'.

❹ Select the '**Call numbers**' menu.

❺ Select the call number to programme (telephone no. 1 to 6), then press 'OK' to confirm. Enter the call number required. Confirm with OK.

Choose the distribution option, that is the way in which you want to be alerted in the event of intrusion: voice or SMS. Confirm with OK.

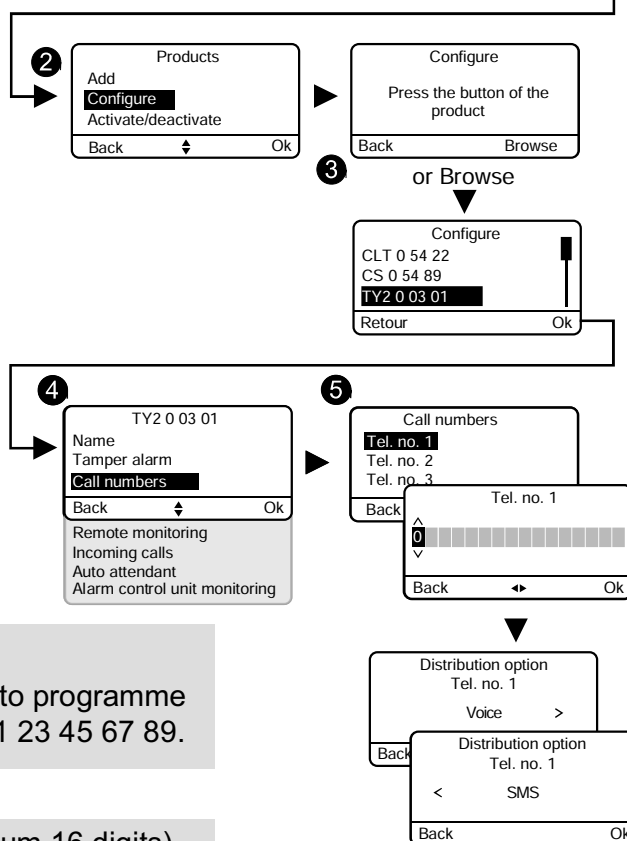

A programmed number with SMS distribution option will automatically receive the video link in case of intrusion. (upon detection of a DMBV TYXAL+ )

### Programming a call from abroad to France:

You are living in a country bordering on France, and want to programme the number 01 23 45 67 89 located in France, dial: 00 33 1 23 45 67 89.

If necessary, you can insert a pause in the dialling (maximum 16 digits) by entering #.

## 2.4 Configuring the SIM card

This menu is used to enter the PIN code of the SIM card to activate it.

❶ Enter the installer code (123456, by default) and confirm with OK.

❷ Press **Settings**, then select the menu:  
**Installation > Products > Configure**

❸ Press the button of the transmitter or select it from the list of products by clicking on '**Browse**'.

❹ Select the '**SIM card**' menu.

❺ Enter the parameters of the SIM card:

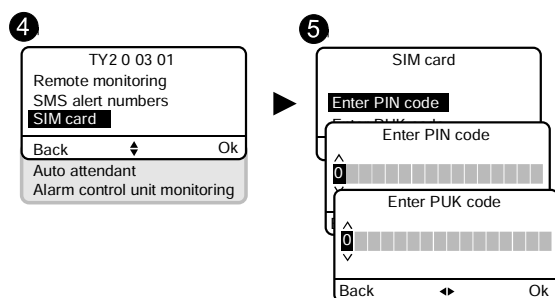

**PIN code**

**PUK code** (if the SIM card is blocked)



## 2. Personalising TYDOM 2.0

### 2.5 Voice/text messages

You can select a voice call  and SMS  for each number in the contact list.

The Voice/SMS option can be configured from the CLT 8000 TYXAL+ touch screen keypad.

Example: you have 5 numbers recorded, of which 2 are SMS. (no.2 and no.4)

- 1 The transmitter dials the first recorded number, if the contact does not pick up or if they do not acknowledge the call, the transmitter then sends an SMS to no.2.

The transmitter continues the cycle and calls no.3, sends an SMS to no.4 then dials the 5th number recorded if no-one picks up.

- 2 If no contact picks up, the transmitter repeats the cycle: no.1, no.3, no.5, etc.

TYDOM 2.0 does not send any other SMS during the following cycles and stops automatically after 4 consecutive cycles.

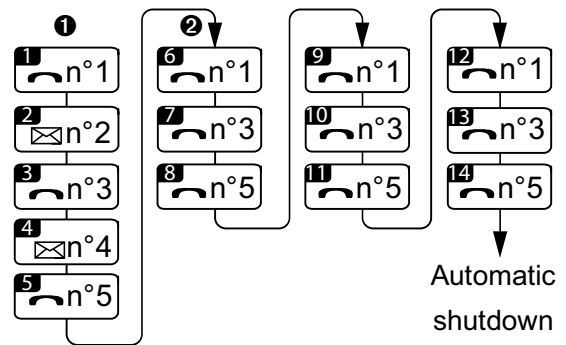

A programmed number with SMS distribution option will automatically receive the video link in case of intrusion. (upon detection of a DMBV TYXAL+)

### 2.6 SMS alert for designated contacts function

This menu is used to send an SMS to a programmed number if the system is switched on or off.

Example: your child comes home and deactivates the system via the remote control or badge reader, the telephone transmitter sends you an SMS.

- 1 Enter the installer code (123456, by default) and confirm with OK.
- 2 Press **Settings**, then select the menu: **Installation > Products > Configure**
- 3 Press the T1 button (external button) of TYDOM 2.0 or select it from the list of products by clicking on **'Browse'**.
- 4 Select the **'SMS alert to relatives'** menu.
- 5 From the list, select the number or numbers concerned by the SMS warning by pressing **Select**.
- 6 Confirm with OK.

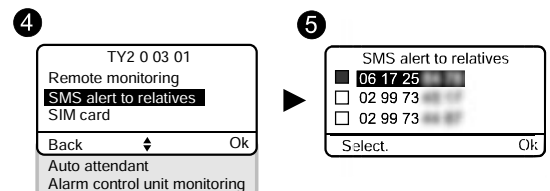

Check that the 'SMS alert to relatives' option is activated in the 'Settings' menu of the remote control or badge associated with the function.

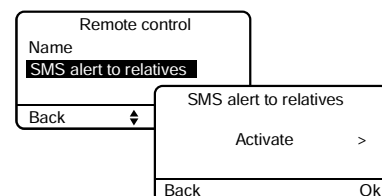

## 2.7 Auto attendant

The auto attendant enables you to obtain vocal information on the status of your installation when you are near the telephone transmitter (e.g. "your alarm system is on"). You can activate or deactivate it.

EN

- ❶ Enter the installer code (123456, by default) and confirm with OK.
- ❷ Press **Settings**, then select the menu:  
**Installation > Products > Configure**
- ❸ Press the button of the transmitter or select it from the list of products by clicking on '**Browse**'.
- ❹ Select the '**Auto attendant**' menu, then 'Activate' or 'Deactivate' (❺).

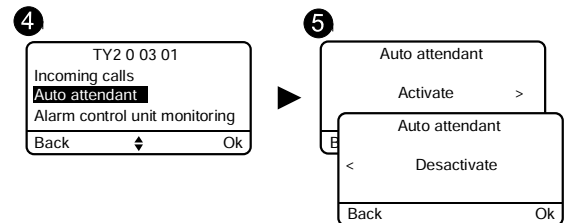

### - Voice/SMS distribution option

Refer to the Call numbers section

### 3. Connect to the system with the TYDOM application

- ② Open the TYDOM application.
- ③ Enter the 6 characters (upper case) in the 'login' field, then enter your password (minimum 8 alphanumeric characters).
- ④ Press the 'Connect' button.
- ⑤ The home screen appears. You are now connected.

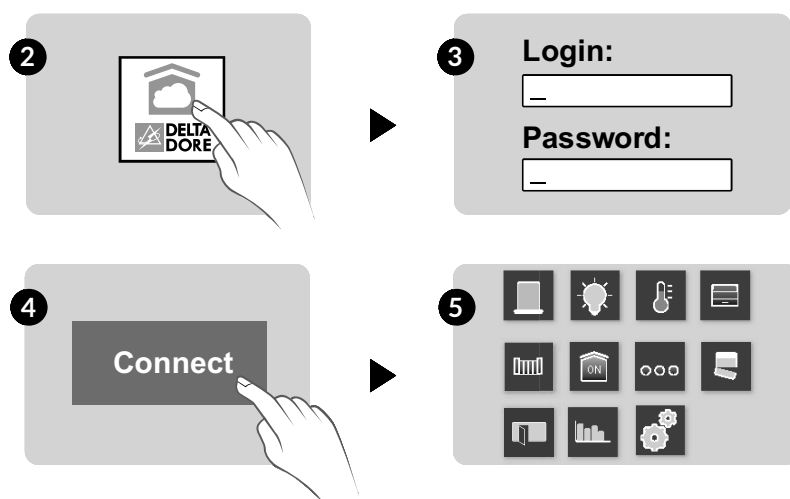

### 4. TYDOM application features



#### 4.1 Home screen

##### Configuration



Settings

Find all the configuration functions of the TYDOM application

##### Functions



Roller shutters



Lighting



Heating



Garage

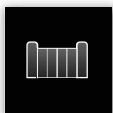

Gate



Alarm

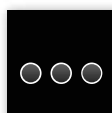

Others

With the application's functions, you can access:

- Creating order groups,
- Adding and deleting products.
- Setting the group receivers to association mode

##### To optimise the use of your application



Scenarios



Rooms

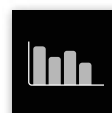

Cons.

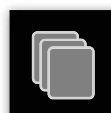

Groups

##### Scenarios:

Combine the selected actions for different functions: Roller shutters, lighting, etc.  
(initial scenario: Shutters down, lighting off.  
Final scenario: shutters open)

##### Command management for each room:

Group the commands for the same room.  
(example: Living room - 3 lights - 2 roller shutters).

##### Consumption management:

Display the history of consumption sources.  
Electricity (consumption can be displayed immediately), Gas, Water, depending on the selected period.  
Display the history of outdoor temperatures over 48 hours (a wireless outdoor sensor is required).

##### Command management for each group:

Group the commands with similar functions.  
(example: all the roller shutters on the ground floor).



## 4. TYDOM application features

### 4.2 Navigation

EN



Home

#### Display the application's home page

This menu displays the functions of the TYDOM application.



Photos

#### Photo mode display

Control the functions of the TYDOM application via photos of your home



Mode configuration

- 1** Take a photo or add a photo of your device and confirm. ☒



- 2** Add a command button then confirm ☒



- 3** Drag the icon to the required location and confirm ☒

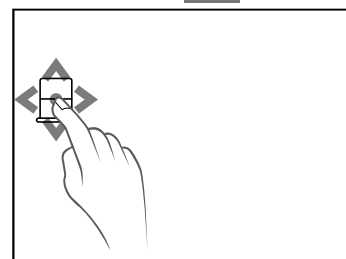

- 4** If necessary, you can modify the button by adjusting:
- The size
  - Background transparency
  - Product name display



Change the scale of buttons



Change the buttons' background transparency



Display the name of the product



Confirm



- 5** **Use**  
Press the photo mode button.



Photos

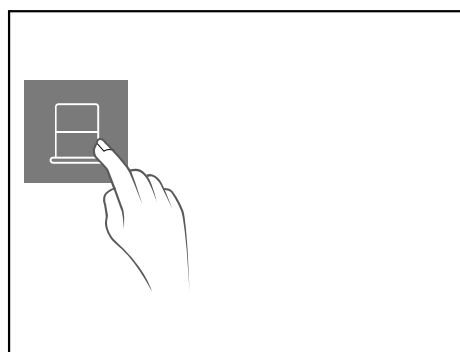

Control the living room roller shutter by pressing the icon

## 4. TYDOM application features

### 4.3 Key to symbols

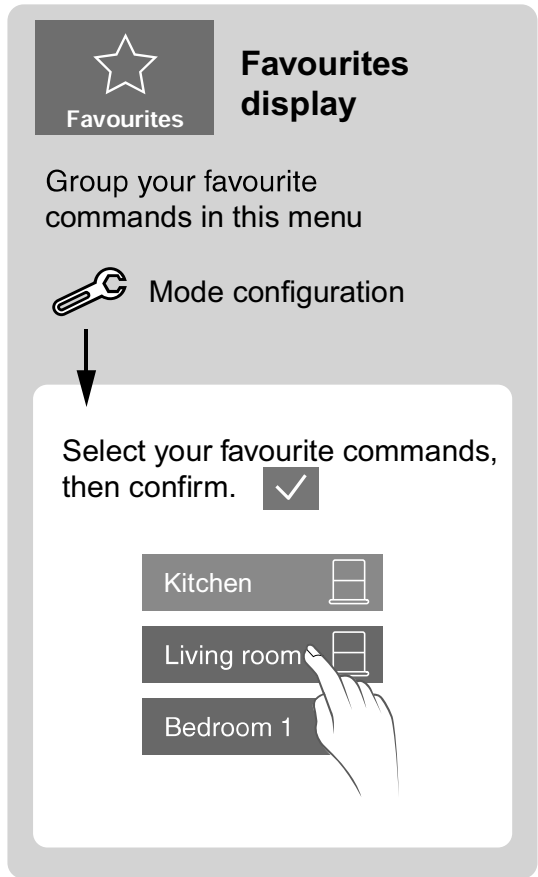

?	Troubleshooting
✓	Confirmation
⚙	Configuration
↶	Back
<	Previous screen
>	Next screen
^	Previous page
✓	Next page
i	Information
⬆⬆⬆	Drag up or down to increase or reduce
🎯	Pulse command
😊	Command performed correctly
⚠	Defect notification
👁	Remote view
📖	Open entry
⬆⬆⬆	Indicates that the icon can be moved

### 4.4 Changing the order of menus

To change the order of menus\*:

- Click and hold a menu item
- Drag it to the required location
- Release

\* The position of menus and groups is not editable

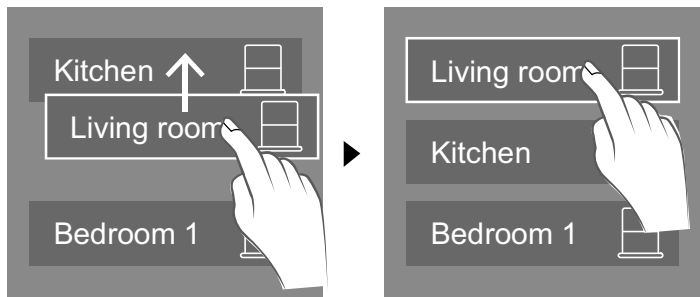

## 5. Correct operation test

Create a detection event to check that the installation is operational.

Switch on the system, and trigger an intrusion. Allow the call cycle to run without touching the OFF button of a control device.

Check that TYDOM 2.0 calls the programmed numbers (6 at most) one after the other until a contact picks up:

- It reads the voice message and specifies the type of defect,
- It asks if you want to listen to what is happening, speak to a person close to TYDOM 2.0, stop the call cycle and obtain the details of the defects if an alarm control unit is associated.

### From TYDOM 2.0:

You can also trigger a test call cycle by pressing the TYDOM 2.0's button for 30 seconds.

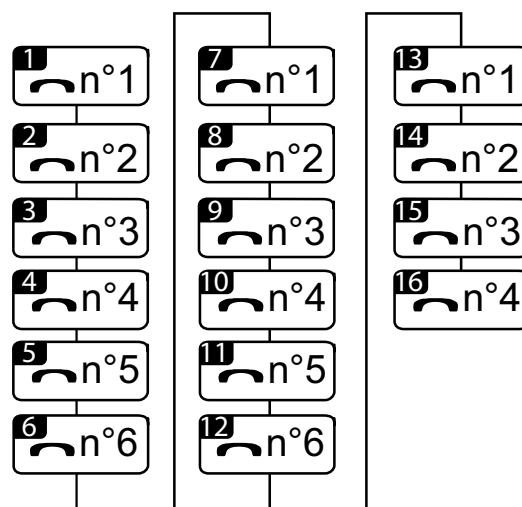
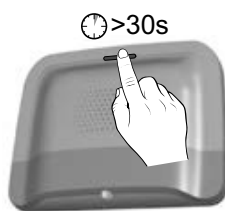

Example of a full cycle with 6 programmed numbers

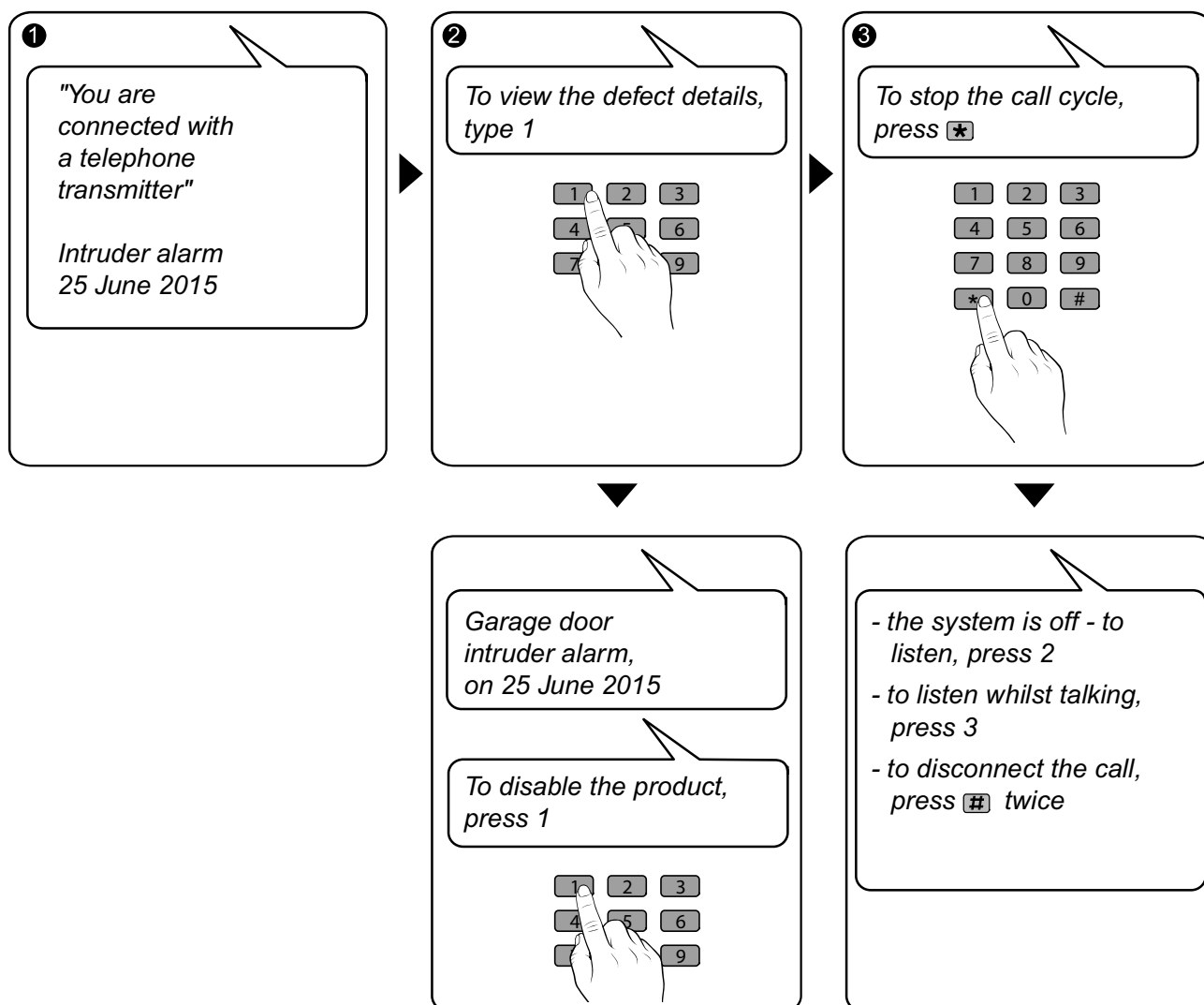

## 6. Telephone line LED status

LED T1	System status
Green on and steady	System accessible locally and remotely Good GSM signal and IP connection OK
Flashing green	GSM call in progress or IP connection in progress
Flashing green/orange	Weak GSM signal and IP connection OK
Red steady	No IP address allocated or no GSM signal

LED T1



## 7. Backup mode

### 7.1 Mains power failure

After 5 minutes of power failure, TYDOM 2.0 sends a notification to the alarm control unit. The alarm control unit beeps.

TYDOM 2.0 sends you a notification of the power defect and continues sending alarms via the GSM connection for 24 hours.

It is no longer controllable remotely.

After the 24 hour period, TYDOM 2.0 switches to energy saving mode, no other function is available.

As soon as the mains power supply is restored, an end of defect notification is sent to the alarm control unit.

The battery is designed to backup 22 power failures for 10 years.

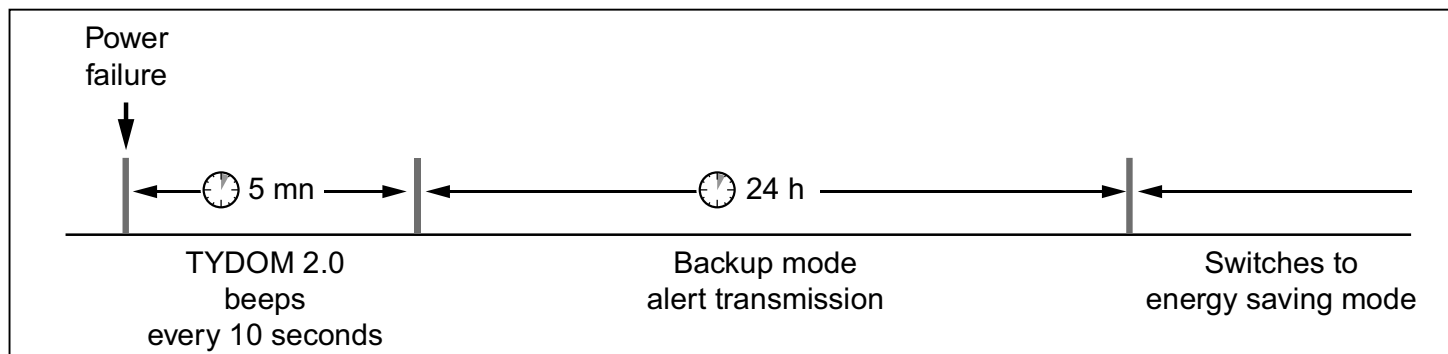
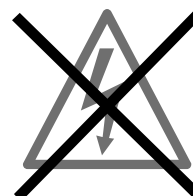

During a power failure, the video transfer function is not available.  
The transfer of video links will resume when the power and Internet access are restored.

## 7. Backup mode

### 7.2 Internet connection down.

After 5 minutes without Internet access, TYDOM 2.0 sends a notification to the alarm control unit.

TYDOM 2.0 continues to send the alerts via the GSM connection, but cannot be controlled by the application. The transfer of video links will resume when the mains power is restored.

You can activate or deactivate the alarm by using the menus proposed by the speech synthesis system of TYDOM 2.0.

- Dial the installation's call number and let TYDOM 2.0 speech synthesis guide you.

As soon as the Internet connection is restored, an end of defect notification is sent to the alarm control unit.

Defects or end of defect detections are stored and can be viewed with the CLT 8000 TYXAL+ touch screen keypad:  
Menu - Info - History logs.

TYDOM 2.0 permanently checks the telephone line and IP connection. In the event of a defect, this symbol  comes up on the touch screen keypad. Enter your access code to discover the details of the defects.

EN

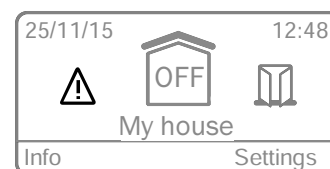
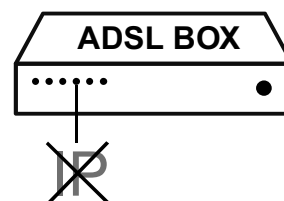

## 8. Battery replacement

A message is sent to the CLT 8000 TYXAL + keypad to alert that the battery is empty.

The alarm control unit beeps each time the system is activated or deactivated, (or “battery defect” with the speech synthesis system (requires the auto attendant to be enabled, see CLT 8000 TYXAL+ guide).



**Switch the alarm control unit to MAINTENANCE mode**  
(see system guide)

**Open the TYDOM 2.0 unit.**

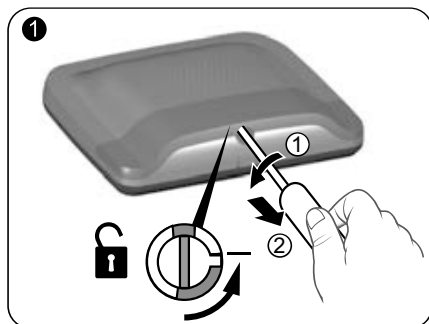

Unlock the unit.



Remove the bottom cover.

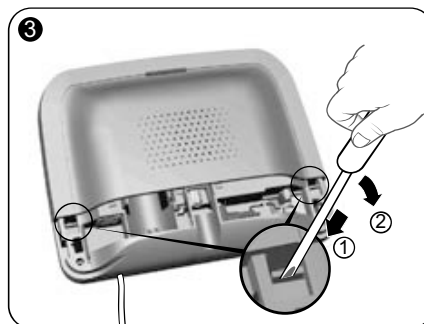

Using a screwdriver, lift the 2 clips holding the top cover.

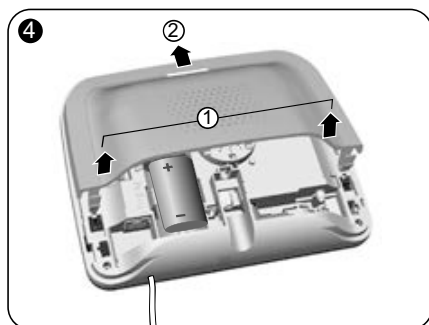

Remove the top cover.

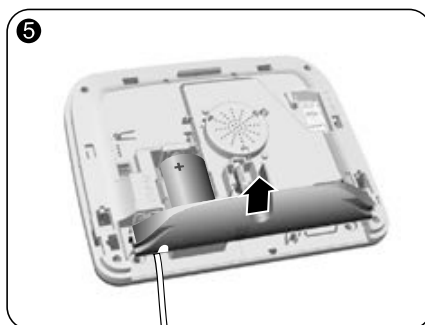

Remove the socket cover.

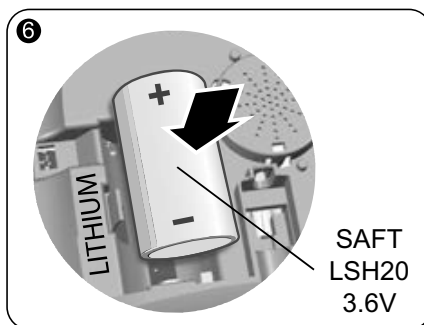

Insert the battery, observing the right polarity.

We recommend using SAFT LSH20 - 3.6 V batteries.



**Handling the battery**  
**Risk of fire, explosion and serious burns.**

- Keep out of reach of children.
- Do not reverse the polarity.
- Do not open the battery system.
- Do not grind or pierce the parts.
- Do not short circuit the (+) or (-) terminals of the battery by using conductive items.
- Do not subject to excessive mechanical stress.
- Do not expose the unit to water or condensation.
- Do not heat directly to more than 100°C (212°F), solder or throw into a fire. These unsuitable uses can cause leaks or sprays of vaporised electrolyte as well as a fire or explosion.
- Do not recharge.
- Dispose in compliance with the regulations in force.

## 9. Advanced functions

Switch the alarm control unit to **MAINTENANCE mode** (see system guide).

Open the TYDOM 2.0 unit.

EN

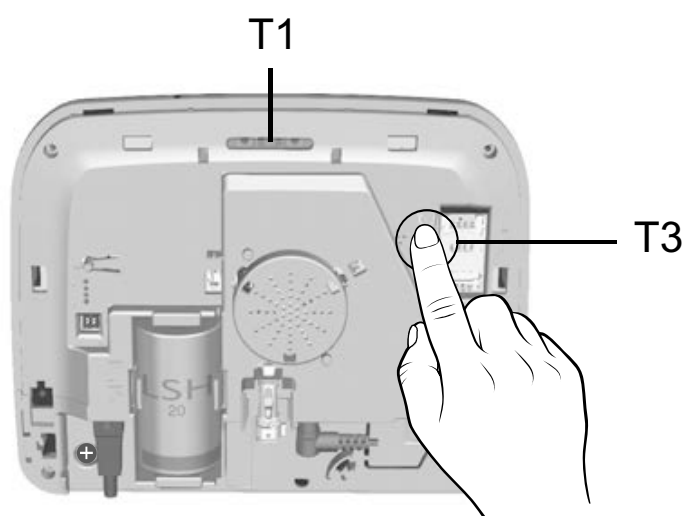

### To change from DHCP to a fixed IP

- Press and hold the T3 button for at least 3 seconds until the T1 LED starts flashing slowly.
- Release the button within 15 seconds

### To delete the password of the TYDOM application

- Press and hold the T3 button for at least 15 seconds until the T1 LED starts flashing rapidly.
- Release the button within 30 seconds

### To RESET TYDOM 2.0

- (Use of DHCP, deleting the password, deleting associations, deleting current defects, restoring factory settings)
- Press and hold the T3 button for at least 30 seconds, TYDOM emits a long beep.
  - Release the button

## 10. Troubleshooting

This section is intended to help you quickly solve the most common problems that you may encounter.

If in doubt, if the problem persists or if it is not in this list, please contact your installer.

### **The intercom quality is poor**

Check that you are not using the hands-free mode of your telephone

### **The room temperature announced by the transmitter is incorrect**

Move the transmitter away from sources of heat (ADSL box, etc.) so as not to bias the measurement of room temperature.

### **The voice interface does not allow you to talk**

TYDOM 2.0 must be powered by a mains power supply.

Check the 230V power supply of TYDOM 2.0.

Move TYDOM 2.0 as far away from the antenna as possible.

### **A detector in the installation causes untimely triggering**

After taking the call and listening to the announcement, disable the relevant product.

### **A call cycle in progress is interrupted and replaced by another call cycle**

The technical detectors are classed in order of priority:

- 1 - Smoke, fire detector (DFR TYXAL+),
- 2 - Water leak detector (DF TYXAL+),
- 3 - Mains power failure detector (DCS TYXAL+),
- 4 - Universal detector (DU TYXAL+).

Example: A fire alert triggered by a DFR TYXAL+ will take priority over the triggering of a mains failure.

### **A call cycle is not fully completed**

Pressing the OFF button on a control device stops the call cycle as soon as the ongoing conversation is over.

### **The 'call numbers' and 'SIM card' configuration menus are not available**

To open these menus, your user code must be configured as 'advanced user', contact your installer.



