

D INSTALLATION DIAGRAMS

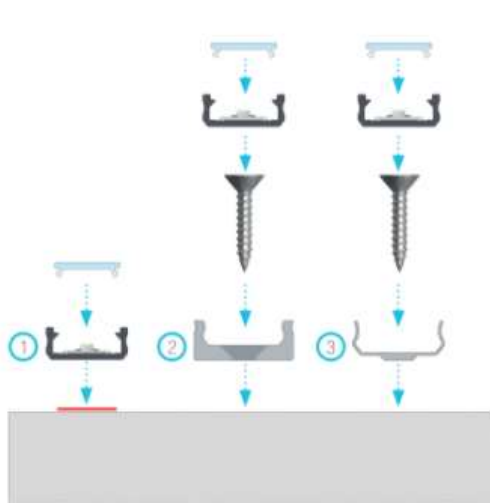

Installation instructions for profile D with a BASIC cover using (1) a double-sided tape, (2) a D MINI mounting clip and (3) a metal D mounting clip

1

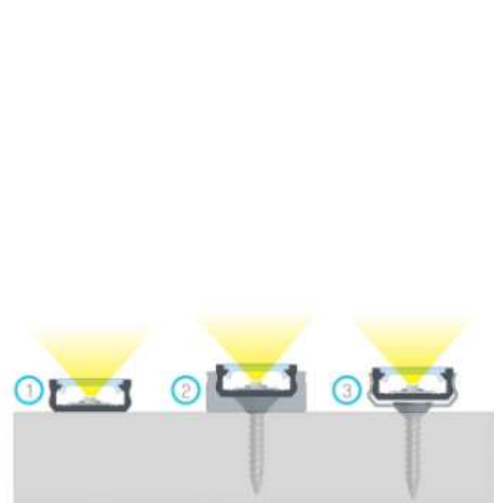

The end result of installation of profile D with a BASIC cover using (1) a double-sided tape, (2) a D MINI mounting clip and (3) a metal D mounting clip

2

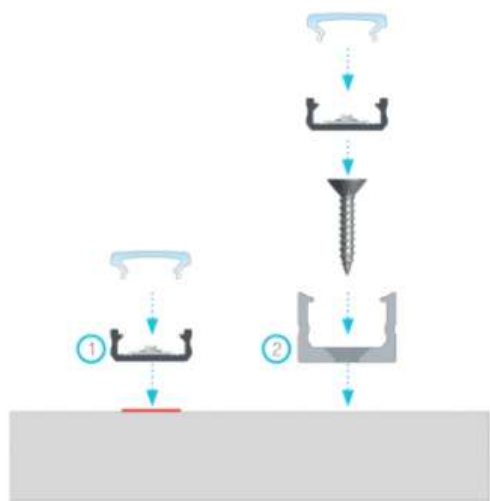

Installation instructions for profile D with a HIGH cover using (1) a double-sided tape, (2) a D HIGH mounting clip

3

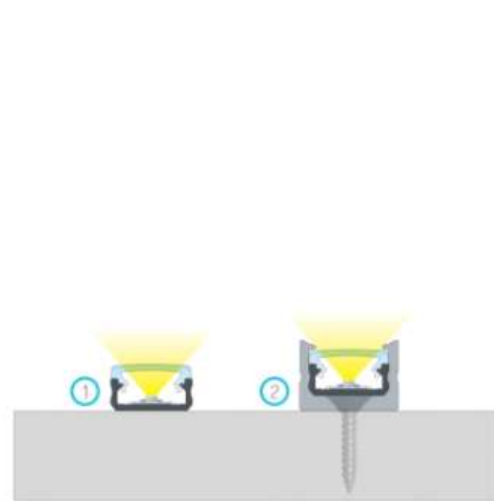

The end result of installation of profile D with a HIGH cover using (1) a double-sided tape, (2) a D HIGH mounting clip

4

5

6



Connecting profiles D with a HIGH cover at 90°

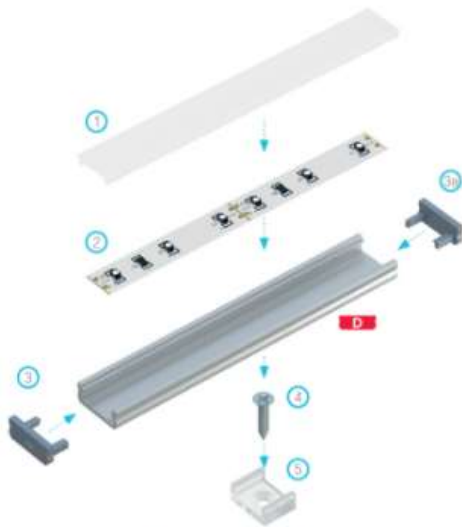

Assembly scheme for elements of the lighting system using (1) a BASIC cover; (2) a LED strip; (3) an end cap with hole; (3a) an end cap without hole; (4) a mounting screw; (5) with a D MINI mounting clip



Assembly of profile D with a BASIC cover with D MINI mounting clips

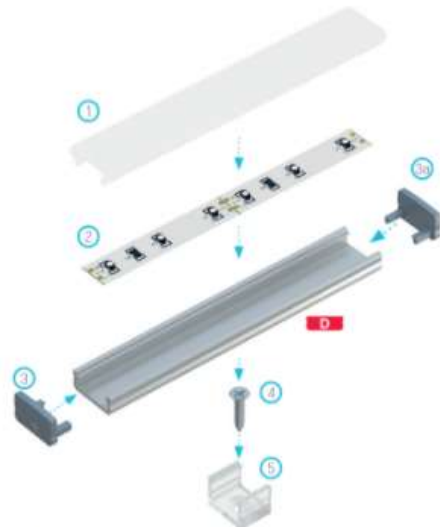

Assembly scheme for elements of the lighting system using (1) a HIGH cover; (2) a LED strip; (3) an end cap with hole; (3a) an end cap without hole; (4) a mounting screw; (5) with a D HIGH mounting clip