

Tycam 1100 - Tycam 2100

EN Installation guide

Tycam 1100
Indoor



Tycam 2100
Outdoor



Legal information

The connection quality of your product may be affected due to changes on the IP architecture on which it operates. These changes may involve (the list is not exhaustive) a change in hardware, software update or configuration operations, work on your operator's equipment or any other multimedia devices such as tablets, smartphones, etc. Android™ and Google play are Google Inc trademarks. IOS™ is a Cisco Systems Inc trademark. Wi-Fi is a Wireless Ethernet Compatibility Alliance trademark. WPS (Wi-Fi Protected Setup) is a standard created by the Wi-Fi Alliance. The camera must be used and installed in accordance with local regulations.

You must respect the privacy of others. It is prohibited to film the public highway or adjoining properties.

You must also inform any persons working in your home (nurse, baby-sitter, etc.), in writing, that they are likely to be filmed temporarily while working.

For more information, consult the video surveillance guides edited by the CNIL.

Data processing

The acquisition of your connected camera implies acceptance of any data processing being carried out. DELTA DORE uses a cloud platform to provide the data processing service. The sequences recorded by your camera will not be stored at any time by the platform providing this service. The videos are only stored and encrypted on the SD card of your camera and can only be accessed using your personal account through the Tydom application.



The use of your camera requires the Tydom application available on Google Play and App Store.

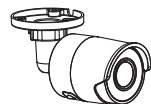

- 1 - Installation recommendations** 5
- 2 - Camera operation** 5
- 3 - Operation of motion detection in one or several zones** 6
- 4 - Operation of image analysis (SMART DETECT)** 6
 - 4.1 Selecting the detection mode 7
- 5 - Tycam 1100 Indoor** 8
 - 5.1 Contents 8
 - 5.2 Description 8
 - 5.3 Support assembly 8
 - 5.4 Mounting 9
 - 5.5 Setting 9
 - 5.6 Memory card 9
 - 5.7 Replacing the memory card 9
- 6 - Tycam 2100 Outdoor** 10
 - 6.1 Contents 10
 - 6.2 Description 10
 - 6.3 Mounting 11
 - 6.4 Setting 11
 - 6.5 Memory card 11
 - 6.6 Replacing the memory card 11
 - 6.7 Impervious sheath for RJ 45 cable 12
 - 6.8 Antenna 12
- 7 - Camera connection** 13
- 8 - Tydom application** 14
- 9 - Factory reset** 14
- 10 - Technical characteristics** 15

Because of changes in standards and equipment, the characteristics given in the text and the illustrations in this document are not binding unless confirmed.

The Tycam 1100 Indoor and Tycam 2100 Outdoor cameras feature a new generation of high resolution sensors providing a great quality image whatever the lighting conditions.

Connected to your ADSL Box, the camera enables you to view your home on your smartphone and record videos and photos vial the Tydom application.

Remotely, you can:

- Observe and listen (*).
- Start a recording instantly.
- Speak with your family and relatives (*).
- View the recorded videos.
- Receive notifications in case of detection.

Image analysis functions

● Motion detection

The camera detects any movement in one or several predefined grid zones.



● Crossing line detection.

The camera detects any person that crosses a predefined detection line.

● Intrusion zone detection

The camera detects any person entering or leaving a predefined detection zone.

The 2 crossing detection modes require specific installation conditions: see §4

Other functions

- Remote surveillance
- Surveillance mode setting
 - Automatic recording on detection
 - Continuous recording
- Recording management (backup, deletion, etc.)
- Notification of events
- Viewing of detection alerts
- Intercom (*)
- Digital Zoom x4
- Night vision
- Reversal of captured image
- Backlight compensation
- Photo capture
- Privacy mode
- 8 cameras max per TYDOM
- Embedded siren (*)
- Possible association by QR Code

(*) TYCAM 1100

1 - Installation recommendations

To achieve optimum operation:

- Avoid installing the camera in an area with strong changes in brightness (backlighting) or one that is too dark.
- Ensure that there is no reflecting surface too near the camera lens.
- Do not install the camera on an unstable support that creates vibrations.
- Avoid proximity to a heat source.
- Do not touch the lens with your finger.
- Do not expose the camera to direct sunlight.
- Do not subject the camera to impacts.
- Install the Tycam 1100 Indoor camera in dry, well ventilated place.
- Electromagnetic radiation can affect video data transmission and image quality. Do not install the camera near a source of electromagnetic radiation.
- The installation must be conducted using the best practice of video surveillance.
- Ensure that all the associated devices are switched off during the installation.
- For equipment connected to the power grid, the socket outlet must be installed close to the equipment and readily accessible.

The 2 crossing detection modes require specific installation conditions: see §4

2 - Camera operation

Maintenance of Tycam 2100

Outdoor cameras:

- Regularly check that there are no insects or spider webs that could trigger false alarms. Use a soft, slightly damp cloth to clean the lens of the outdoor camera.
- Periodically check the wiring and connections of your camera.

Video recording

- The videos are automatically deleted after 30 days.
- When the storage limit of the card is reached, the oldest videos are deleted automatically.
- The recording time can vary according to the movement in the

image. These values are given for information only and cannot be guaranteed.

- The lifetime of the memory card will depend on the SD card used. Only the SD card supplied with the camera ensures an operational life of 2 years.

Videos are recorded in "medium" resolution quality.

Each video recorded upon detection starts 5 seconds before the event for a total duration of 35 seconds

3 - Operation of motion detection in one or several zones

Tycam 1100/2100 cameras monitor the zone or zones via video analysis to detect any motion.

Tycam 1100 also features heat detection by a passive infrared sensor (PIR).

Materialise the zones you want to monitor according to a grid in the Tydom application.

This detection mode requires no specific installation conditions.



4 - Operation of image analysis (SMART DETECT)

To obtain an optimum analysis of motion in its field of vision, position the camera at a sufficient height and distance from the zone to monitor.

Camera height

Tycam 1100 Indoor - h: 2 m minimum

Tycam 2100 Outdoor - h: 4 m minimum

Distance from the zone to monitor

Recommended fields of vision :

Minimum: 2.5 m/Maximum: 10m (TYCAM 1100) or 30m (TYCAM 2100)

Minimum angle of camera axis: 15°.

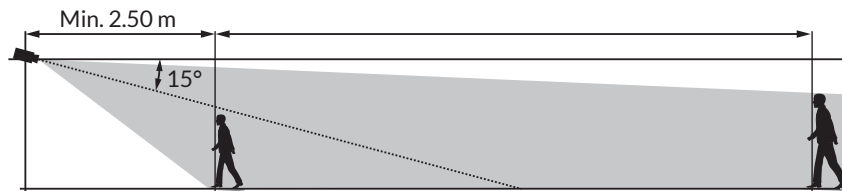
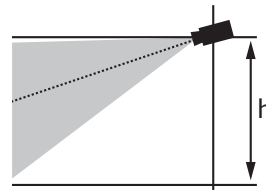

Ensure that a person detected does not appear too small nor too large in the image.

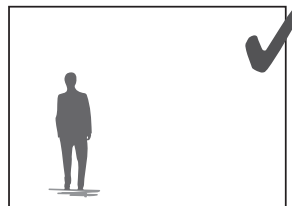
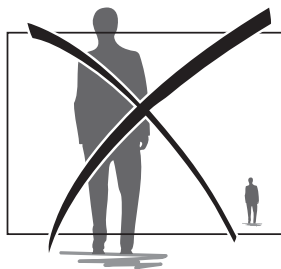

4.1 Selecting the detection mode

Using the Tydom application, select the detection mode suited to the monitored zone.

4.1.1 Crossing zone detection

This mode is recommended for external cameras.

Direct and position the camera at the recommended height to ensure reliable crossing detection.

Define a crossing line in the Tydom application, any person crossing this line is detected.

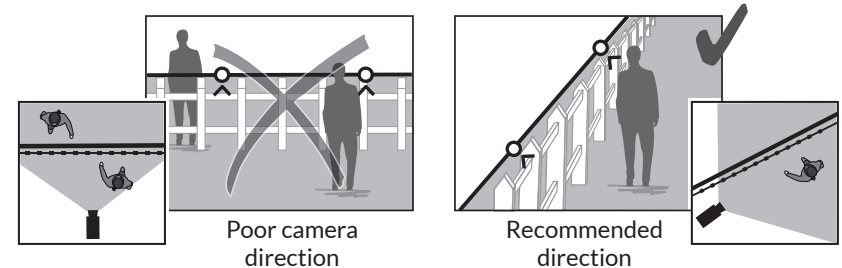

4.2.2 Intrusion zone detection

Move the corners of the rectangle in the Tydom application to define an intrusion zone. Any person entering the zone is detected.

To ensure reliable detection, ensure that the zone to monitor is not at the edge of the image.

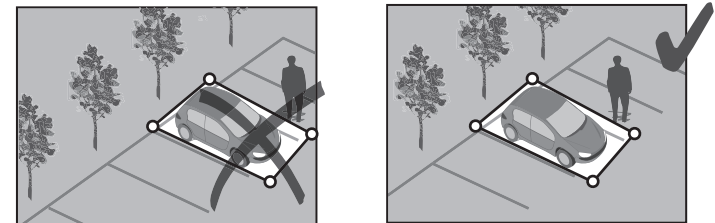

- Follow the installation guidelines to get the best use out of the camera: Height/Distance/Camera position angle.
- Whatever the operating mode chosen, you can adjust the detection sensitivity using the Tydom application.
- When you finish configuring the camera, it is vital to run a detection test to ensure that camera correctly analyses the scene to monitor and effectively detects movements.

5 - Tycam 1100 Indoor

5.1 Contents

- 1- Camera
- 2- Support
- 3- EU plug
- 4- UK plug
- 5- Mains adaptor
- 6- Installation guide
- Regulatory documents
- 7- RJ 45 cable

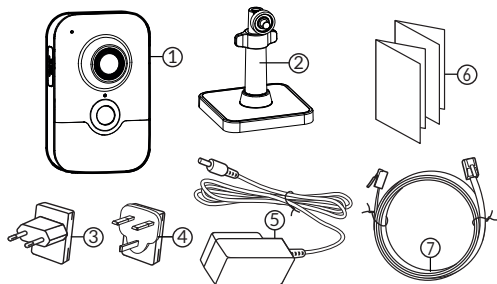

5.2 Description

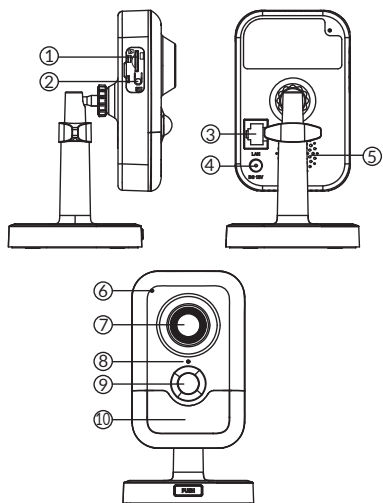

- 1- Memory card location
- 2- RESET/WPS button
(Open the protective cover).
- 3- RJ45 Network Connector
- 4- Power supply socket
- 5- Loudspeaker
- 6- Microphone
- 7- Lens
- 8- Status LED

Red and steady: Camera start.

Blue and steady: The camera is connected to the network.

Flashing red: Network connection error.

Flashing blue: Camera is communicating on the network.

Fast flashing red: Safety installation.

Fast flashing blue: Camera updating.

Red/Blue alternative flashing: Pending QR Code reading for WiFi association

- 9- PIR (passive infrared sensor)
- 10- Infrared LED (night vision)

5.3 Support assembly

- Screw the support to the back of the camera.
- Place the camera on a flat surface.
- Loosen nut B,
- Point the camera correctly then tighten nuts A and B.

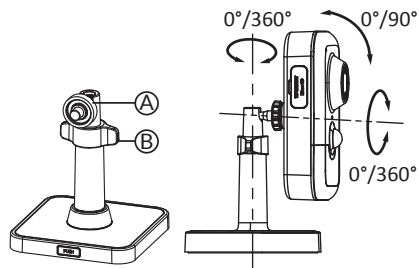

5.4 Mounting

You can mount the camera on a wall or ceiling.

- Press the 'PUSH' button to separate the support from the base.
- Drill the base mounting holes.
- Mount the base with suitable screws for the support.
- Clip the support onto the base by aligning the 3 stops.

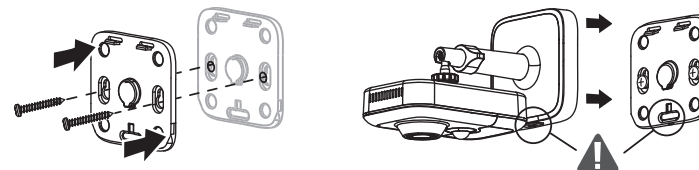
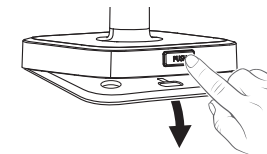

5.5 Setting

- Loosen nuts A and B,
- Point the camera correctly then tighten nuts A and B.

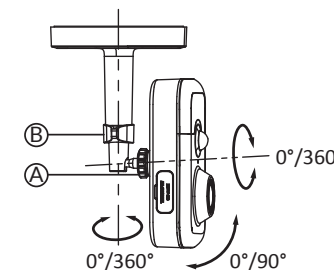

5.6 Memory card

The Tycam 1100 Indoor camera is already fitted with a 16 GB memory card.

This card records encrypted videos that can only be read by the Tydom application. You can increase the recording capacity by installing a card with a greater capacity (Micro SD/ SD HC/ SD HX class 10 required).

Memory card	Continuous recording time
8 GB	12h
16 GB	24h
32 GB	2,5 days
64 GB	5 days
128 GB	10 days

Note: Videos recorded on another card model will not be encrypted.

5.7 Replacing the memory card

- Turn off the camera power supply.
- Open the protective cover.
- Insert the new memory card in the direction indicated.
- Format the card using the Tydom application.

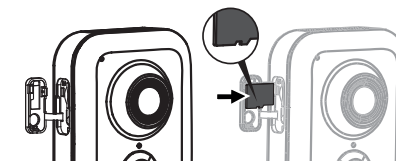

6 - Tycam 2100 Outdoor

6.1 Contents

- 1- Camera
- 2- Connectors
- 3- EU plug
- 4- UK plug
- 5- Mains adaptor
- 6- Memory card cover key
- 7- Antenna socket plug
- 8- Drill template
- 9- Impervious sheath for RJ 45 cable
- 10- Installation guide Regulatory documents
- 11- RJ 45 cable

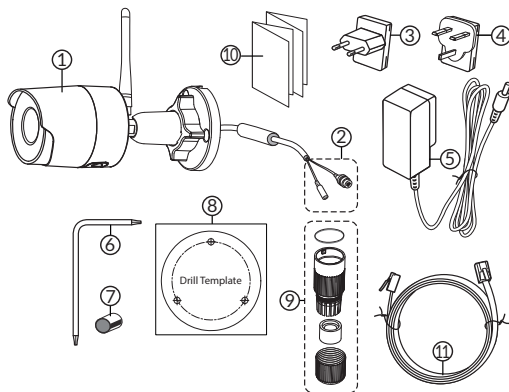

6.2 Description

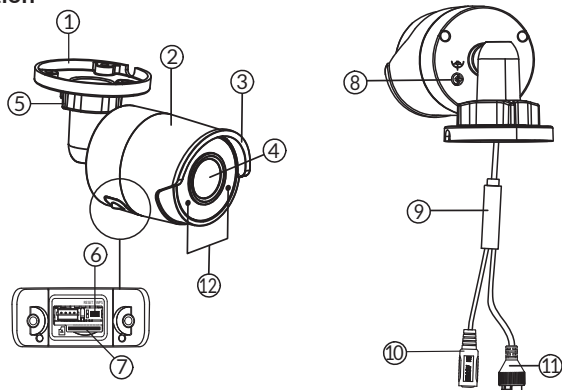

- | | |
|--|---|
| <ol style="list-style-type: none"> 1- Base 2- Camera 3- Sun visor 4- Lens 5- Clamping screw 6- RESET/WPS button
(Remove the 2 screws from the cover using the key supplied). 7- Memory card location 8- Earth connection (Optional connection) 9- PoE cable | <ol style="list-style-type: none"> 10- Power supply socket 11- RJ45 Network Connector 12- Infrared LED (night vision)
Slow flashing: QR Code reading confirmation / Security set up
Fast flashing: Pending QR Code reading for WiFi association / Updating the camera. |
|--|---|

6.3 Mounting

- Drill the mounting holes using the drill template.
- Mount the base with suitable screws for the support.

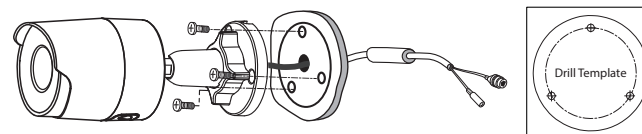

6.4 Setting

- Loosen nut A,
- Point the camera correctly then tighten nut.

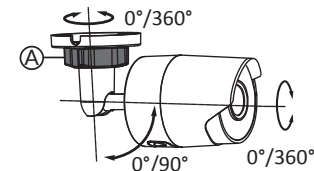

For installations that require wiring for outdoor sockets, a sealed connection box is available as an option.

BRE Tycam 2100 Outdoor - Ref: 6417008

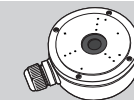

6.5 Memory card

The Tycam 2100 Outdoor camera is already fitted with a 16 GB memory card.

This card records encrypted videos that can only be read by the Tydom application. You can increase the recording capacity by installing a card with a greater capacity (Micro SD/ SD HC/ SD HX classe 10 obligatoire).

Note: Videos recorded on another card model will not be encrypted.

Memory card	Continuous recording time
8 GB	12h
16 GB	24h
32 GB	2,5 days
64 GB	5 days
128 GB	10 days

6.6 Replacing the memory card

- Turn off the camera power supply.
- Remove the 2 screws from the cover using the key supplied.
- Insert the new memory card in the direction indicated.
- Format the card using the Tydom application.

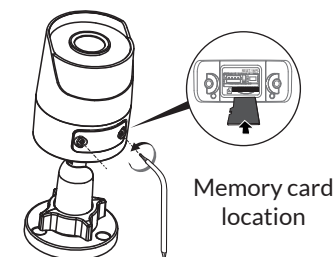

6.7 Impervious sheath for RJ 45 cable

If necessary, you can fit the sealing accessory for the RJ 45 cable.

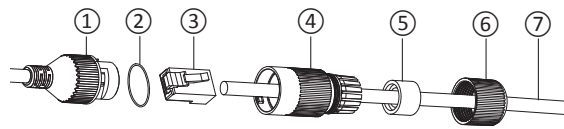

- 1- Camera network interface socket
- 2- Seal
- 3- Network plug
- 4- Seal plug
- 5- Rubber seal
- 6- Clamping nut
- 7- Network cable from the ADSL BOX

1. Pass the network cable (7) (without plug) through the clamping nut (6), the rubber seal (5) (inner edge of the rubber seal must be opposite the seal plug), then through the seal plug (4), in this order.
2. Crimp an RJ-45 network plug (3) onto the end of the cable, taking care to insert the twisted pairs of wires in the right order.
3. Place the seal (2) on the tip of the camera network interface socket (1).

4. Insert the network plug (3) into the camera network interface socket (1).
5. Insert the rubber seal (5) into the seal plug (4), then screw the clamping nut (6) onto the seal plug (4) without tightening it completely.

6. Align the seal plug snap-fit system (4) with the notch on the camera network interface socket (1), then screw the seal plug (4) a quarter turn on the camera network interface socket (1).

7. Tighten nut 6, the sealed connection of the RJ45 plug is complete.

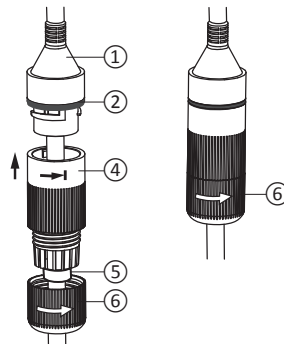
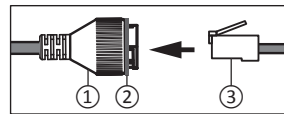

6.8 Antenna

If you are using the WIFI mode to connect the camera to your local network (see § 4), screw the antenna manually onto the camera.

If you are using another connection mode, fit the antenna socket plug to ensure the antenna socket is sealed.

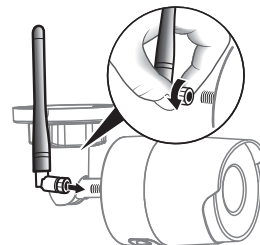

7 - Camera connection

Connect the camera to your local network.

Select your connection mode:

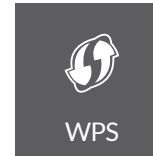
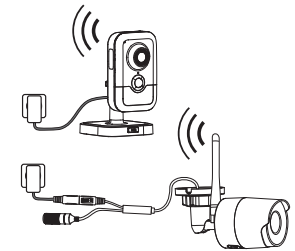
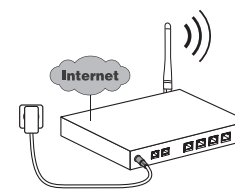

Connection modes by WIFI link.

The local WIFI network must be secure.

WPS connection: Check the compatibility of your ADSL BOX.

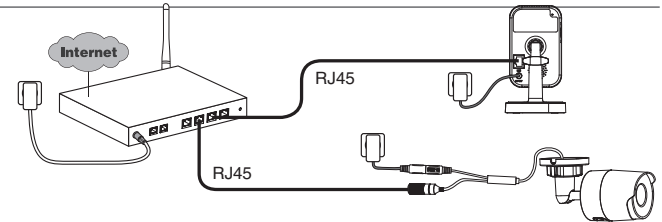
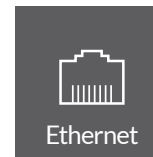

Connection mode by Ethernet RJ45 link (Cat. 5E, max. 100m).

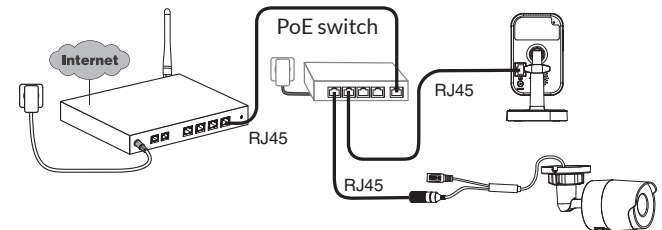
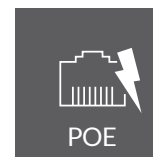

The PoE connection mode is used to power the camera by the Ethernet RJ45 link. It requires a Switch or PoE Injector to be installed as well as a category 6 Ethernet cable (not supplied).

Max. length according to the switch used (Poe SW4: 250m max)

PoE switch option: PoE SW4 Ref: 6417010

ADSL Bitrate

The ADSL bitrate can vary according to the quality of the line and its use. The resolution of the camera must be adapted according to the available bitrate.

In the event of a remote connection problem, change the camera resolution in the application.

The ADSL box requires 100 kbit/s for its own operation.

Réglage de la résolution	Débit montant utilisé par caméra
High	900 kbit/s
Average	450 kbit/s
Low	300 kbit/s

Example: You have an upstream bandwidth of 650 kbit/s, set the resolution of your camera to average quality.

8 - Tydom application

Switching on for the first time

- When switching the camera on for the first time or resetting it, the time needed to set up the connection with the secure server is around 2 minutes. It can take up to 7 minutes if a software update is required.



Associate your camera with the Tydom application, making sure that your smartphone or tablet is connected to the local network.

Run the Tydom application and follow the instructions. You can associate up to 8 cameras.

9 - Factory reset

You can initialise your camera to return to factory settings.

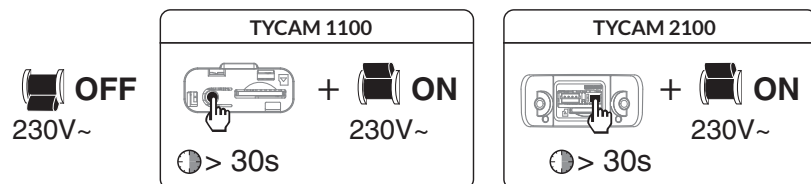

- Turn off the camera power supply.
- Press and hold the RESET button.
- Keep the button pressed and turn the power back on.
- Hold the button down for 30 seconds until the camera emits a «click / click».
- Release the button.

Once your camera is initialised, you must remove it from the account via the Tydom application.

10 - Technical characteristics

	Tycam 1100 Indoor	Tycam 2100 Outdoor
Power supply	INPUT : 100-240V~ 50-60 Hz 0,3A OUTPUT : 12V ~ 1A Or PoE (802.3af Class3)	
Consumption	7 W	5 W
RJ45 Network	Ethernet 10/100 Mbps	
Wi-Fi network	Wi-Fi IEEE 802.11 b/g/n	
Optical sensor/ Focal distance	1/2.8" 2 Megapixels HD CMOS/f 2.8mm	1/2.5" 2 Megapixels HD CMOS/f 2.8mm
Viewing angle	H 108°/V 59°/Diag: 129°	H 107° / V 56° /Diag : 127°
Minimum light intensity	0 Lux (with infrared LED)	
Night vision	EXIR 2.0 Automatic - Range: 10 m	EXIR 2.0 Automatic - Range: 30 m
Resolution	→ Full HD -1920x1080 pixels @25 ips (image per second) depending on connection quality	
Video compression	H.264, H.265	
Micro SD card/ SD HC/ SD XC	16 GB - Can be extended up to 128 GB - (Class 10 obligatory)	
Customised detection	•	•
Bidirectional audio	•	-
Embedded siren	Max 85 db	-
Operating temperature and humidity	-10°C/+40°C 10% ~ 95% without condensation	-30°C/+60°C 10% ~ 95% without condensation
Storage temperature and humidity	-20°C/+60°C - 0% ~ 90% without condensation	
Degree of protection	-	Water spray resistant IP 67
Dimensions	103 mm x 66 mm x 33 mm	Ø 70 mm x 165 mm
Weight	128 gr	410 gr



www.deltadore.com

07/19



2705094 Rev.05